

LOOP POWERED INDICATOR - 5 DIGIT L.E.D. DISPLAY

PANEL MOUNT

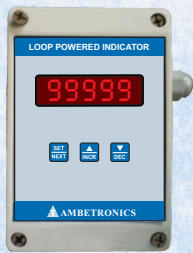

WEATHERPROOF



LPI-500-FLP



Magnetic Wand for Programming

- Exd IIA/IIB T6 IP - 65
- CMRI/PESO Tested Enclosure

FLAMEPROOF

LPI-500-FLP-PDA



Magnetic Wand for Programming

- Exd IIC T6 IP - 66
- CMRI Tested Enclosure

LPI-500-FLP



Magnetic Wand for Programming

- Exd IIC T6 IP-66
- CMRI/PESO Tested Enclosure

ILLUSTRATION

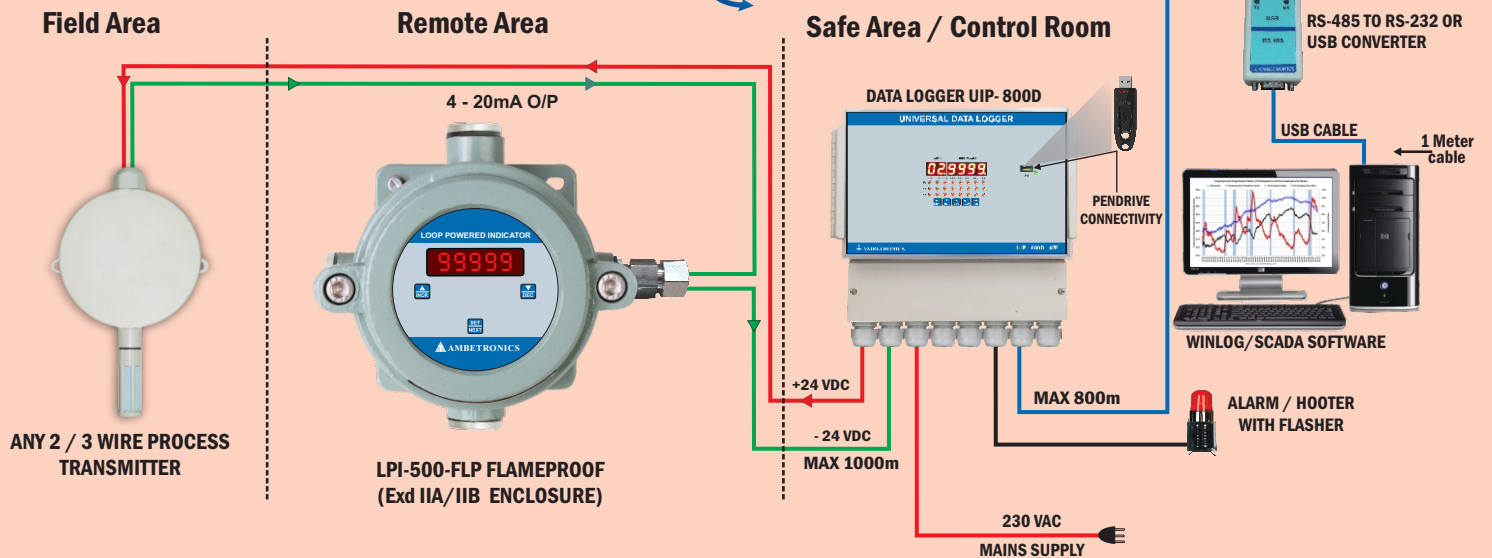

FEATURES

- ◆ User Programmable With Password Protection
- ◆ Easy Programming With Push Buttons for WP & PM Model
- ◆ Non-Instrusive programming for Flameproof model using Magnetic Wand.
- ◆ Temperature coefficient of accuracy 0.005% FS/°C
- ◆ Software Calibration – No Trimpots
- ◆ Reverse Polarity Protection
- ◆ Loop Voltage Drop < 4.8 VDC
- ◆ 4 - 20 mA Loop Current Input from Transmitters
- ◆ Accuracy ± 0.1% Of Full Scale Range
- ◆ 5 Digit L.E.D Display
- ◆ Range Locking / Unlocking Facility
- ◆ Offset Facility To Compensate Field Error
- ◆ Operational Mode Linear / Square Root; Programmable by user
- ◆ No external Power Supply is required

APPLICATIONS

- ◆ Provides Process value Indicator in various Industrial Control & Measurement Application such as Pressure, Flow, Level, Temp., Humidity etc.
- ◆ Remote Indicator at point of measurement or at control end especially where there is no power source
- ◆ Being Non Voltage Producing Device can be directly used in Hazardous Area with Suitable Enclosure
- ◆ Replaces an Analog Meter with no additional wiring and power connection
- ◆ Can be inserted at any point in signal loop as a stand alone as it requires no external power
- ◆ Remote Indication location on tank taps as used in liquid level sensing & control

MUST FOR HUMAN AND INDUSTRIAL SAFETY

TECHNICAL SPECIFICATIONS

General :

Input	: 4-20 mA Loop Current Input from any 2 / 3 Wire Process Transmitter
Range	: -19999 to 99999
Resolution	: 1, 0.1, 0.01, 0.001
Offset	: Adjustable upto $\pm 10\%$ of range
Display	: 0.39" 5 Digit Red LED Display
Display Update Rate	: Linear mode : 1 sec; Square root mode : 1sec
Status Indication	: i) Display shows 'Under/Undr', when Input current falls below set 'UNDER' value (from 3.6mA to 3mA, settable) ii) Display shows 'Over', when Input current goes above set 'OVER' value (from 20.5mA to 21mA, settable)
Operational Mode	: Linear & square root; programmable by user
Calibration	: Software calibration

Performance :

Accuracy	: Linear : $\pm 0.1\%$ of span; Square root : $\pm 0.2\%$ of span
Temperature coefficient of accuracy	: 0.005%FS/°C
Warm up Time	: 10 Sec

Electrical :

Loop Voltage Drop	: < 4.8 V DC, @ 24VDC
Short-circuit protection and Reverse polarity protection	

Environmental :

Operating Temperature	: -10°C to 50°C
Relative Humidity	: Below 95% non condensing

Panel Mount Housing :

Protection Class	: IP-40
Cabinet Material	: ABS Plastic, Black colour
Cable Entry	: Terminal Connector for Connection
Dimension	: 96 (H) x 96 (W) x 85 (D) -in mm
Mounting	: Panel Mounting
Weight	: Approx 250 Grams

Weatherproof Housing :

Protection Class	: IP- 65
Cabinet Material	: Polycarbonate, Grey colour
Cable Entry	: 1No., Thermoplastic Cable Gland (IP-68)
Dimension	: 121 (H) x 101 (W) x 59.5 (D) -in mm
Mounting	: Wall Mounting / Stand Mounting
Weight	: Approx 250 Grams

Flameproof Housing :

Protection Class	: IP- 65
Approval	: CMRI approved for IIA & IIB Gas Group
Cabinet Material	: Cast Aluminium alloy, LM-6 / C.I. Enclosure
Cable Entry	: 1No., Double compression cable gland (EX-proof), 3/4" ET-Type
Dimension	: LPI-500-FLP - 148 (H) x 185 (W) x 95 (D) -in mm
Mounting	: Wall Mounting / Stand Mounting
Weight	: Approx 1 Kg

Note : For other Flameproof Model housing (IIC, CMRI/PESO Tested) Dimensions will be provided on request.

ENCLOSURE DIMENSIONS

WEATHERPROOF ENCLOSURE

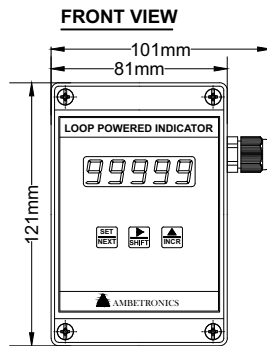
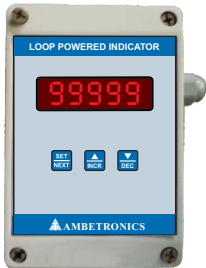

NOTE: 1) ALL DIMENSION ARE IN mm.
2) SIZE : 101(W) X 121(H) X 59.5(D)

SIDE VIEW

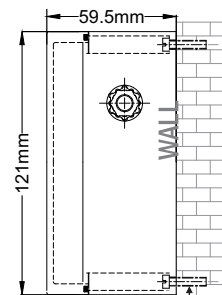

3 x 25 SELF THREAD SCREW : 4 Nos.

BACK VIEW

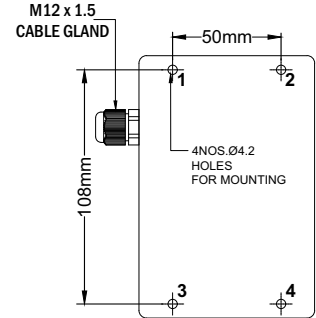

FLAMEPROOF ENCLOSURE

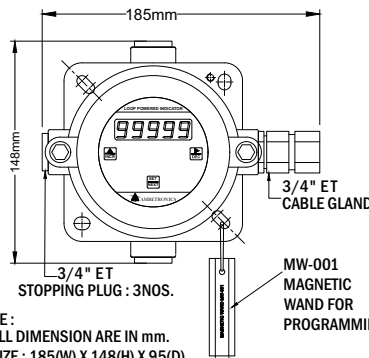

NOTE: 1) ALL DIMENSION ARE IN mm.
2) SIZE : 185(W) X 148(H) X 95(D)

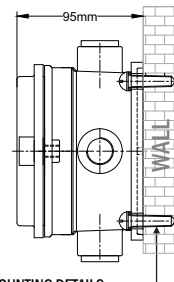

MOUNTING DETAILS
1) METAL WASHER : ID-6mm, OD-12mm : 4 Nos.
2) 5 X30 CHIPBOARD SCREW : 4Nos.

EARTHING DETAILS
SCREW-M5 x 8
S. S. PLAIN WASHER ID-5, OD-10 - 2 Nos.
SERRATED WASHER - 1Nos.

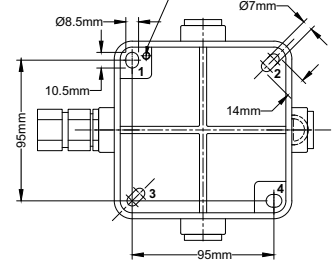

ORDERING INFORMATION

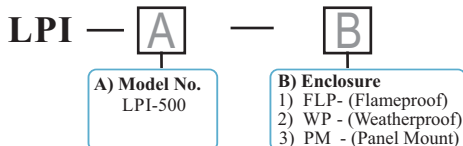

*** Before placing order, Refer ordering information or Contact below address for assistance.**

Manufactured by :

AMBETRONICS ENGINEERS PVT. LTD.

17-B, Tarun Industrial Estate, Mogra Pada, New Nagardas Road, Andheri (E), Mumbai -400 069, India. • Mob.: 9324571143

Tel.: +91-22-61673000/32, 28371143 • E-mail : sales1@ambetronics.com • sales@ambetronics.com • Web : www.ambetronics.com



Version : LPI-500-W/FSJ/FP-R1-12.04.19