

LOOP POWERED TRANSMITTER FOR GAS GT- 1033-FLP

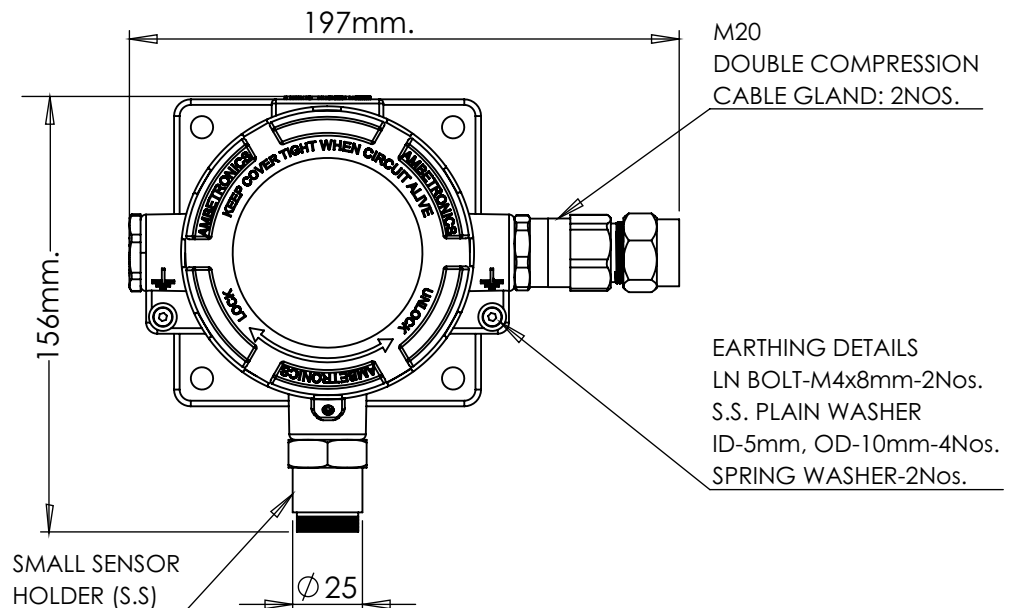

FRONT VIEW



BACK VIEW

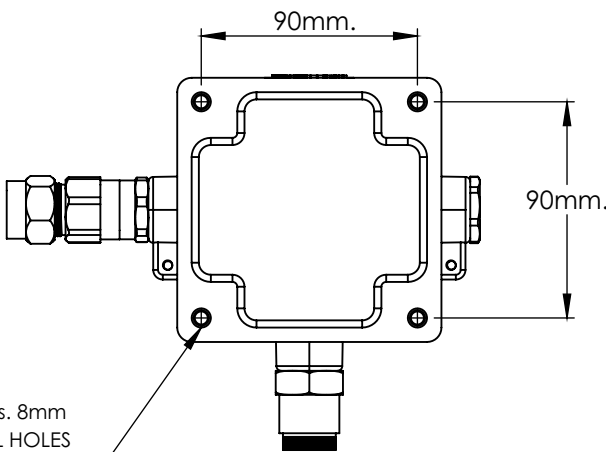

4 Nos. 8mm
DRILL HOLES
FOR WALL
MOUNTING

SIDE VIEW

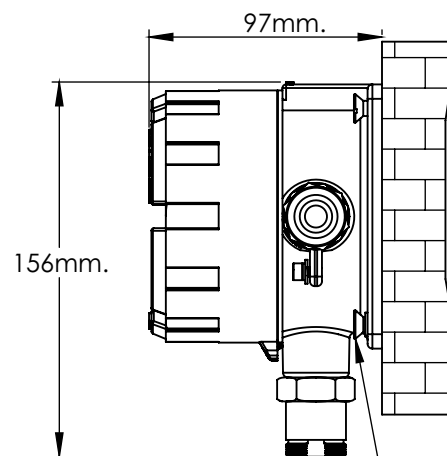

MOUNTING DETAILS :

- 1) METAL WASHER:
ID-6mm, OD-12mm: 4Nos.
- 2) M5x30mm CHIPBOARD SCREW: 4Nos.

FEATURES

- Industrial Standard, 4-20mA output with Respect to Gas Concentration.
- Loop Test, Assures Proper Operation of the Transmitter without Calibration Gas
- Easy Programming with Password Protection.
- Fast Response, Easy to Read Display.
- Easy to Replace Sensor Module; On Field Plug-N-Play module.
- Reverse Polarity Protection.
- No Additional Power Required.
- Highly Reliable, Fast, Accurate for Specific Gas Detection.
- Excellent Long Term Stability.
- User Friendly, Simple to Operate & Easy to Install.
- Reduced Operating, Maintenance and Installation Cost, One Man Calibration.
- Sensor Open/ Over Range Indication.
- Inhibit mode for service purpose, current output settable as per the requirement.
- EMC compliance to IEC - 61000-4 standards.

APPLICATIONS

- Gas Metering skid
- Gas Cylinder Bank
- Oil & Gas Industries
- Gas Pipeline Project
- Refineries
- Cold Storage
- Sewage Plants
- Fertilizers Plants
- Stack Monitoring
- Chlorination Plant
- Ambient Monitoring
- Pulp & Paper Plants
- Control Atmosphere
- Heat Treatment Plants
- Chemical Processing Plant
- Acid Alkalize & Dyes mfg. Plants
- Offshore Drilling & Processing Platform
- Chemical Storage Area
- Coal Mine and Confined Area
- Power & Industrial Plants
- Bullets Yards / Storage Yard
- Chemical & Petrochemical Plants
- Gas Metering Station Burner / Furnace Areas
- Automotive Industrial/Paints Shops

TECHNICAL SPECIFICATIONS

GENERAL

Sensors	: Electrochemical Sensor/NDIR
Range/Resolution	: As specified in the Table
Detection Method	: Diffusion
Response Time	: Less than 10sec.
Display	: 2 line,4 digit Segmental LCD Display
Set Point	: Two independent set point, with alarm symbol for indication purpose. (There is no relay output)
Setting	: By using Magnetic Wand for Flameproof Model. By using Front Keys for Weatherproof Model.
Output	: 4-20mA with HART enable

ACCURACY

Toxic/O₂	: ±2% of the full Scale Range.
NDIR CH₄	: ±0.2% V/V or ± 5% of Applied Gas.

ENVIRONMENTAL

Operating Temp.	: -15°C to +50°C
Storage Temp.	: -10 °C to +60°C

ELECTRICAL

Power Supply & Load Resistance	: Load Driving capacity as follows:
	a) 820 Ω at 24VDC to 36VDC
	b) 680 Ω at 22VDC to 36VDC
	c) 560 Ω at 20VDC to 36VDC
	d) 47 Ω at 8VDC to 36VDC

OUTPUT SIGNAL

Standard	: 4-20 mA Loop current output with configurable range.
-----------------	--

OPTIONAL ACCESSORIES

- CE certified 24 VDC power supply
- Gas sampling & conditioning system
- Canopy & Mounting stand

ERROR MONITORING

- During Sensor break/ open the display shows 'OPEN' & Loop current will be Upscale/ Downscale.
- During Over Range the display shows 'OVER' & loop current will be Upscale/ Downscale.
- Upscale current = 21mA
- Downscale current = 3.7mA
- Inhibit mode current adjustable 3.8mA/ 4mA (for Toxic/NDIR) & 3.8mA/17.4mA (for Oxygen), user programmable.

FLAMEPROOF HOUSING

Degree of Protection Class	: IP-66 / IP-68
CIMFR CERTIFICATE NO.	: IN/CIMFR/TR20/3007 Dt. : 22/10/2020
Housing Material	: Cast Aluminium LM6 alloy or Stainless Steel
Cable Entry	: Flameproof, Weatherproof IP66 Double Compression Cable Gland - Model No.: CG/FLP/2C M20 x 1.5 (P) & M25 x 1.5(P), ½" NPT & ¾" NPT
CIMFR CERTIFICATE NO.	: TC/P/1313 Dt. : 19/09/2018
PESO CERTIFICATE NO.	: P431645/2 Dt. :19/11/2019
Dimension	: 160 mm (H) with sensor holder x 195 mm (W) with one cable gland & Stopping Plug x 97 mm (D)
Mounting	: Wall Mounting / Stand Mounting / Pipe Mounting
Weight	: Approx 1.25 Kg

ELECTROCHEMICAL SENSOR TECHNOLOGY

SR. NO	GASES	RANGE	UNIT	RES.
O1	Oxygen (O ₂)	25	% Vol.	0.01
NT1	Nitrogen (N ₂)	75 TO 100	% Vol.	0.1
TOXIC GASES				
T1	Ammonia (NH ₃)	100	PPM	1
T2	Ammonia (NH ₃)	1000	PPM	1
T3	Bromine (Br ₂)	10	PPM	0.01
T4	Carbon Monoxide (CO)	1000	PPM	1
T5	Carbon Monoxide (CO)	2000	PPM	1
T6	Chlorine (CL ₂)	10	PPM	0.01
T7	Ethylene Oxide(ETO)	100	PPM	1
T8	Hydrogen (H ₂)	2000	PPM	1
T9	Hydrogen Bromide (HBr)	100	PPM	1
T10	Hydrogen Chloride (HCL)	100	PPM	1
T11	Hydrogen Cyanide(HCN)	100	PPM	1
T12	Hydrogen Fluoride (HF)	10	PPM	0.01
T13	Hydrogen Fluoride (HF)	100	PPM	1
T14	Hydrogen Sulfide (H ₂ S)	100	PPM	1
T15	Ozone (O ₃)	20	PPM	0.01
T16	Phosphine (PH ₃)	10	PPM	0.01
T17	Nitrogen Dioxide (NO ₂)	20	PPM	0.01
T18	Nitric Oxide(NO)	250	PPM	1
T19	Sulfur Dioxide (SO ₂)	50	PPM	0.1
T20	Sulfur Dioxide (SO ₂)	2000	PPM	1
NDIR SENSOR TECHNOLOGY				
N4	Methane (CH ₄)	100	%LEL	1

NOTE:

- In above Table, Range of gases start from zero.
- Gases which are not listed, are available on request & for other details contact factory.

ORDERING INFORMATION

GT →	A	→	B
	↓		↓
	A. MODEL 1. 1033 - WP 2. 1033 - FLP		Select name and range of the Gas from the above list

NOTE :

Select order code e.g. GT-1033-FLP-T8 i.e.
GT-1033 - Flameproof Enclosure - Hydrogen 2000 PPM

Manufactured by :



AMBETRONICS ENGINEERS PVT. LTD.

17-B, Tarun Industrial Estate, Mogra Pada, New Nagardas Road, Andheri (E), Mumbai - 400 069, India.

Mob.: +91-9320619646 • +91-9320621646 • Tel.: +91-22-61673000/27 /31/32

E-mail : project@ambetronics.com • sales@ambetronics.com • Web : www.ambetronics.com

Follow us on



Version : GT-1033-FLP-(JB-90)-OXYGEN-R1-21-05-2022